

Update Cabot Koppers Superfund Site

February 4, 2014

Recent Activities

- Offsite Remediation

- Preliminary Offsite Remediation Zone Identified
- Extent of Offsite Contamination Not Complete-- Additional Sampling Planned by EPA in February
- Offsite Soil Removal Pilot (NW 30th Ave)
- Beazer Obtained Permissions for Survey Work
- Beazer Developing Specific Remediation Plan of Each Parcel
- Beazer Hired Landscape Designer and Arborist
- Plans Require Property Owner Approval
- Start of Remediation First Blocks – Week of Feb 10

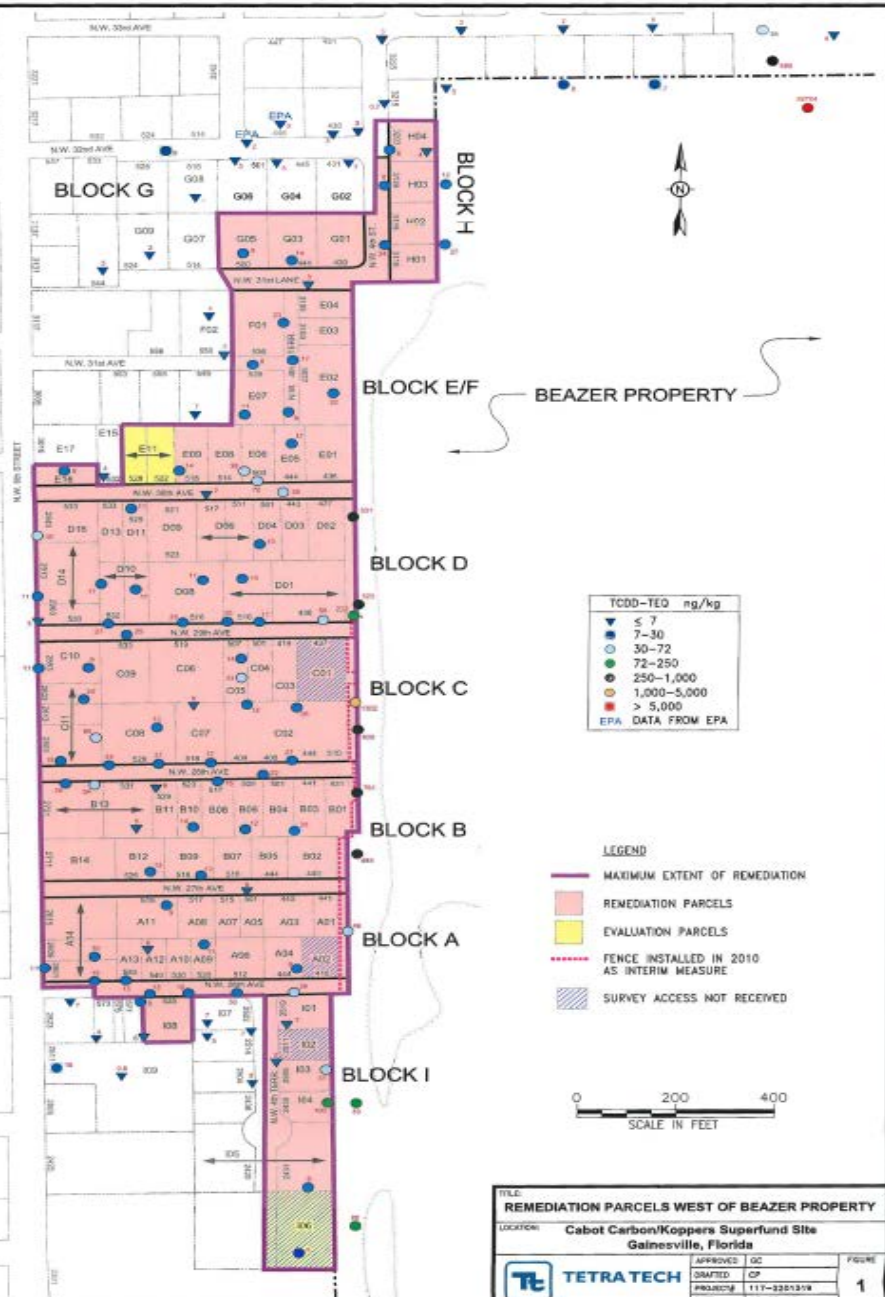

TCDD-TEQ ng/kg

▼	≤ 7
●	7-30
○	30-72
●	72-250
●	250-1,000
●	1,000-5,000
●	> 5,000
●	EPA DATA FROM EPA

- LEGEND**
- MAXIMUM EXTENT OF REMEDIATION
 - REMEDIATION PARCELS
 - EVALUATION PARCELS
 - FENCE INSTALLED IN 2010 AS INTERIM MEASURE
 - SURVEY ACCESS NOT RECEIVED



TITLE: REMEDIATION PARCELS WEST OF BEAZER PROPERTY			
LOCATION: Cabot Carbon/Koppers Superfund Site Gainesville, Florida			
	APPROVED	GC	FIGURE 1
	DRAFTED	CP	
	PROJECT	117-3321319	
	DATE	10-29-13	

Surface Soil (0-6") Data for Dioxins (TCDD-TEQ) (ng/Kg)

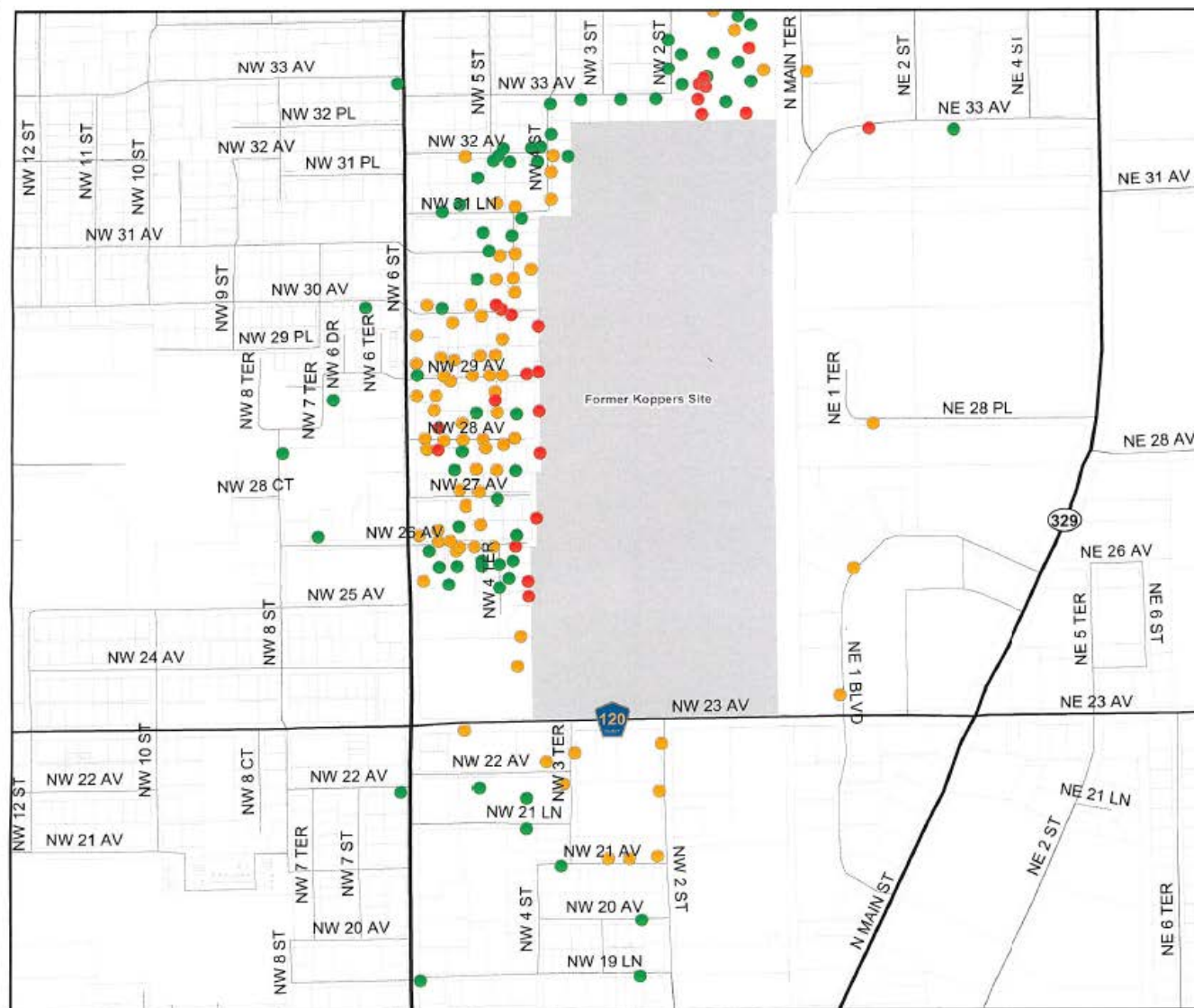

Update December 2013

TCDD-TEQ_n

- ≤ 7.0 ng/Kg
- >7.0 and ≤ 30.0 ng/Kg
- >30.0 ng/Kg

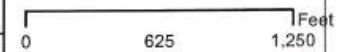

Map Legend

- Former Koppers Site
- Concentration Above FDEP Commercial SCTL
- Concentration Above FDEP Residential SCTL
- Concentration Below FDEP Residential SCTL

DISCLAIMER: This map and the spatial data it contains are made available as a public service, to be used for reference purposes only. The Alachua County Environmental Protection Department provides this information AS IS without warranty of any kind, implied or expressed, regarding accuracy, completeness, or fitness of use. The quality of the data is dependent on the various sources from which each data layer is obtained.

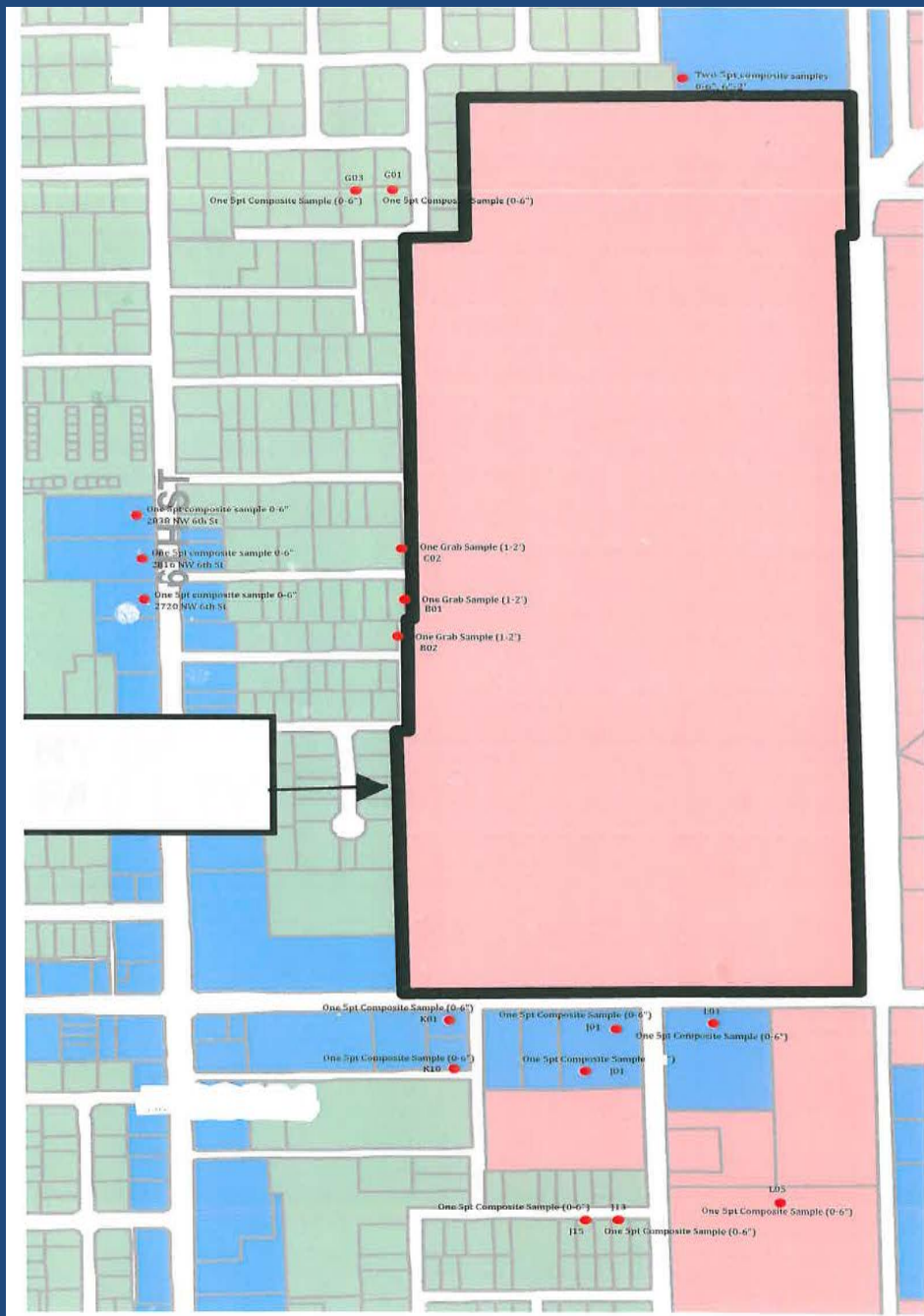

Planned Supplemental Offsite Soil Sampling Locations for Dioxins by EPA February 2014

Sample soils on Mixed Use Commercial and Residential Properties along 6th Street and South of Site

Additional samples at 1 ft. to 2 ft. near the site boundary

Recent Activities

- Remedial Design Plans (Schedules and Process)
- Institutional Control Plan
- Soil Characterization in Process Area on Site to Design and Implement In-Situ (ISGS) Treatment Demonstration Project

On-Site ROD Remedy for Former Koppers Site

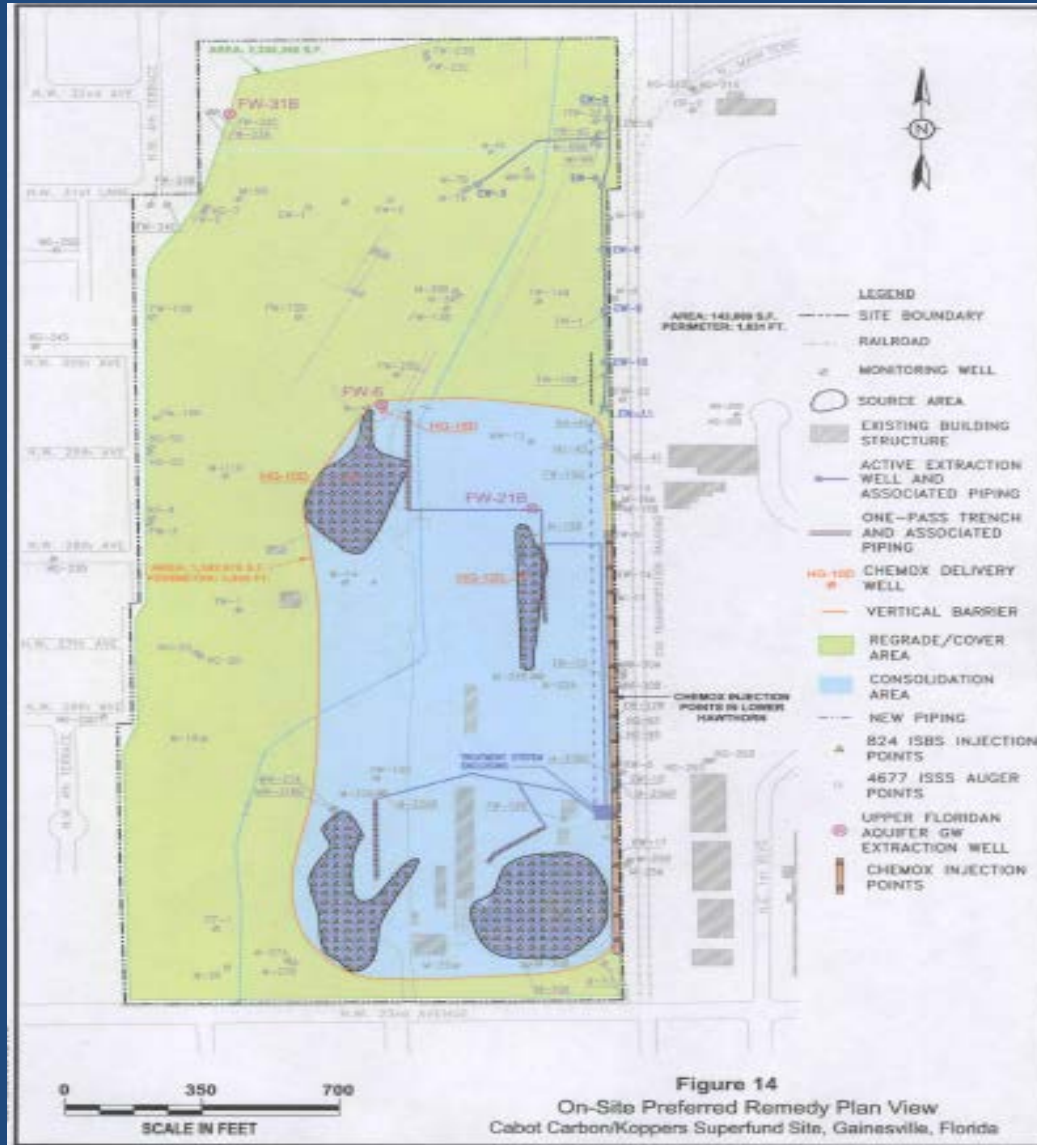
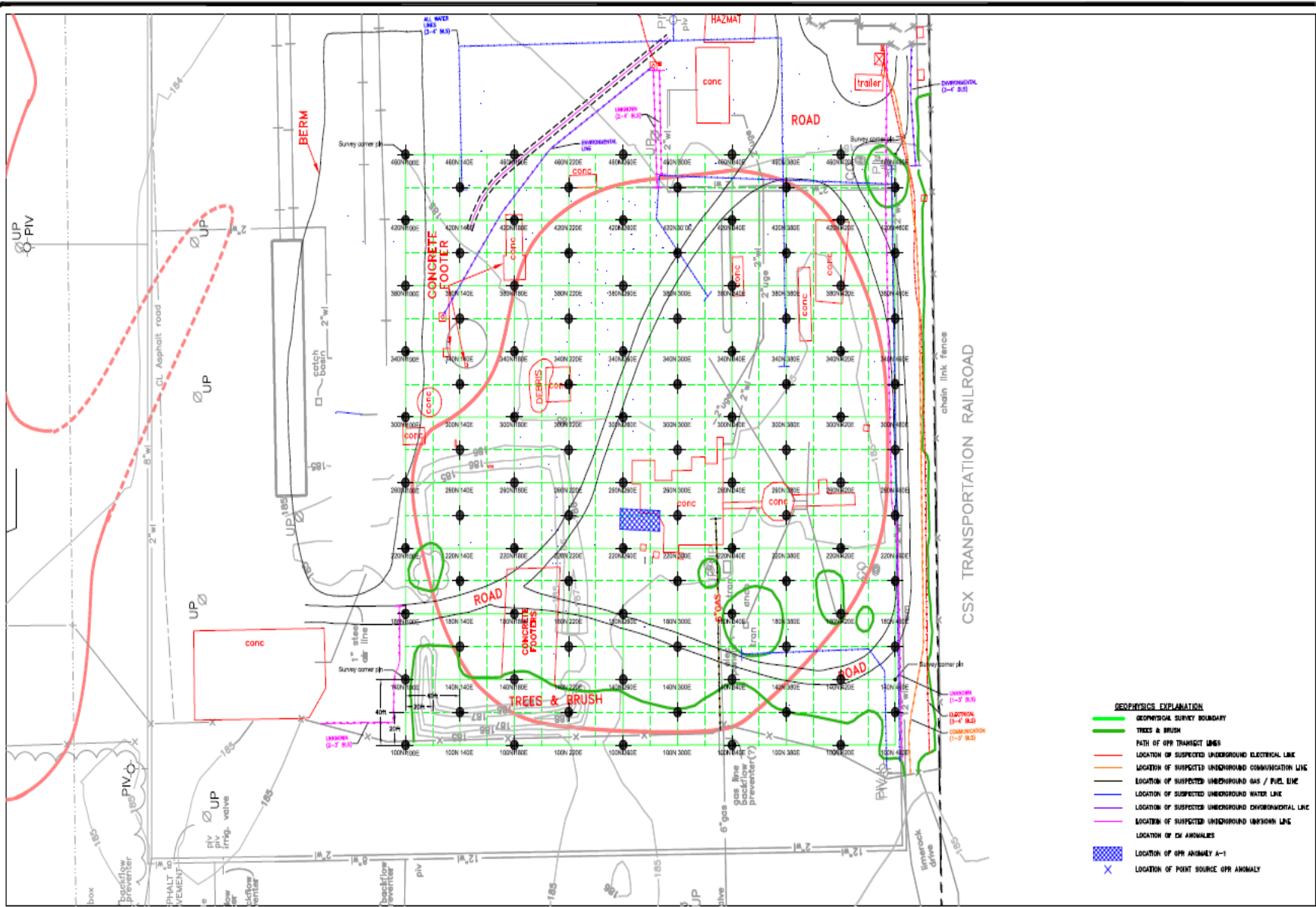

Figure 14
On-Site Preferred Remedy Plan View
Cabot Carbon/Koppers Superfund Site, Gainesville, Florida



EXPLANATION

- LATERAL EXTENT OF DNAPL SOURCE AREAS WITHIN THE SURROUNDING ASBESTOS PROJECTED VERTICALLY TO THE SURFACE
- PRELIMINARY GRID FOR DNAPL CHARACTERIZATION BORINGS
- KOPERS PROPERTY BOUNDARY

BORING AND SAMPLE ID NOMENCLATURE

USE GRID COORDINATES FOR BORING ID. EXAMPLE: 161N 141E.
 IF BORING IS SHIFTED MORE THAN 3 FEET FROM THE ORIGINAL PROPOSED LOCATION CHANGE BORING ID TO MATCH COORDINATES AT THAT LOCATION. EXAMPLE: FOR BORING ID SHIFTED 3 FEET NORTH AND 7 FEET EAST FROM ORIGINAL GRID POINT 141N 141E, 141N 141E, SAMPLES WOULD BE THE BORING ID FOLLOWED BY A SPACE FOLLOWED BY THE SAMPLE INTERVAL. EXAMPLE: FOR SAMPLE FROM 16-17 FEET FROM BORING 141N 141E: 141N 141E 16-17.

GEOPHYSICS EXPLANATION

- DECEMBER SURVEY BOUNDARY
- TREES & BRUSH
- PATH OF GPR TRANSMIT LINES
- LOCATION OF SUSPECTED UNDERGROUND ELECTRICAL LINE
- LOCATION OF SUSPECTED UNDERGROUND COMMUNICATION LINE
- LOCATION OF SUSPECTED UNDERGROUND GAS / PNEUM. LINE
- LOCATION OF SUSPECTED UNDERGROUND WATER LINE
- LOCATION OF SUSPECTED UNDERGROUND ENVIRONMENTAL LINE
- LOCATION OF SUSPECTED UNDERGROUND UNKNOWN LINE
- LOCATION OF CH ANOMALIES
- LOCATION OF GPR ANOMALY A-1
- X LOCATION OF POINT SOURCE GPR ANOMALY

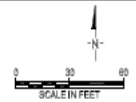

Title		PROCESS AREA ISDS CHARACTERIZATION GRID	
Client		Cabrè Carbon/Asbestos Superfund Site, Columbus, Florida	
Scale	ASB	Sheet No.	1
Date	08/11/2011	Scale	ASB

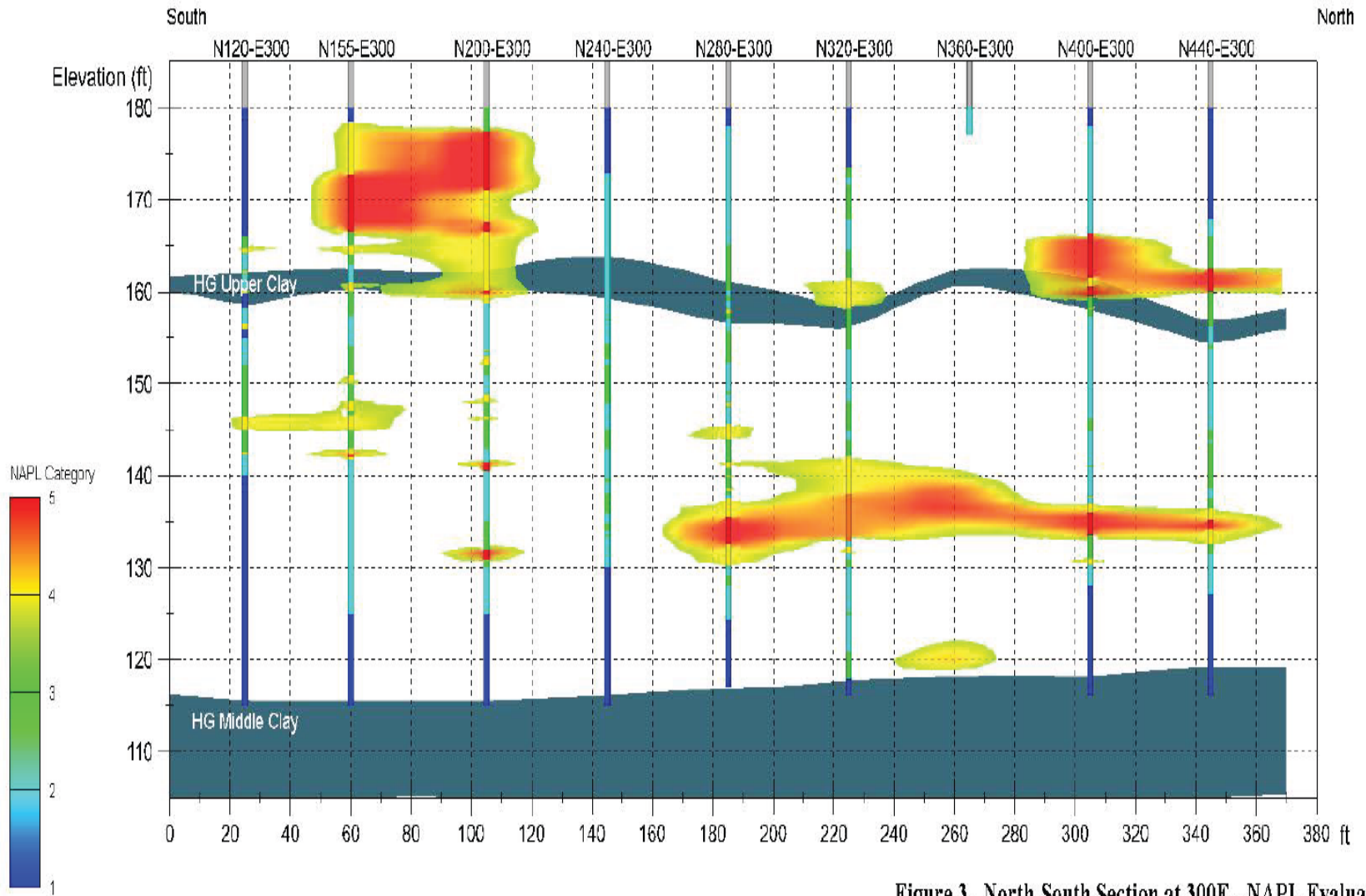

Figure 3. North-South Section at 300E - NAPL Evaluation

Investigations at Former Cabot Site

